

Application and Adjustment for the Manual Arm-Height Adjustor

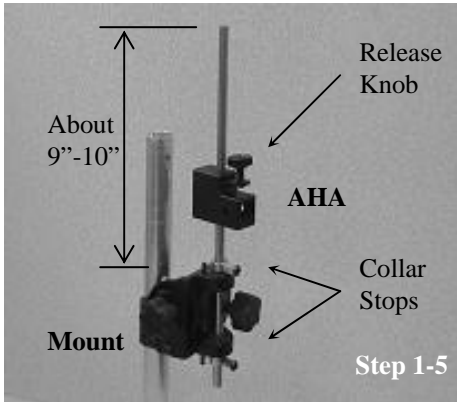

1. Attach the mount to the wheelchair (WC), and unscrew the bubble level from the 14" rod.
2. Place the rod into the ball bearings of the mount such that a collar stop can be attached to it below the mount. It is suggested that nine to ten inches of the rod should protrude above the mount.
3. Secure the rod in place using two collar stops; one is placed just above the mount and one is placed just below.

4. Turn the release knob on the arm-height adjuster (AHA) counter-clockwise until resistance is met. Press the release knob down with the thumb, and hold it down.
5. Slide the arm-height adjuster onto the 14" rod with the release knob on top. The arm-height adjuster will self lock when the knob is released.
6. Orient the multilink arm to the desired side (R-L), and remove the 5/16" set screw at the proximal/lateral end of the arm.



7. Insert the proximal end of the multilink arm into the arm-height adjuster.
8. Align the holes on the sides of the multilink arm with the corresponding holes on the arm-height adjuster. Place the flanged button-head screw (provided) into the lateral hole and tighten it completely. (Note: The first time this screw is tightened all the way, resistance may be felt)

9. The height of the multilink arm can be adjusted in either direction while the release knob is pressed down. (Note: Hold the arm-height adjuster with the fingers underneath and thumb on top. The other hand provides distal support)

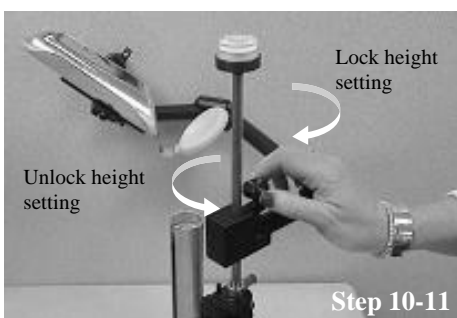
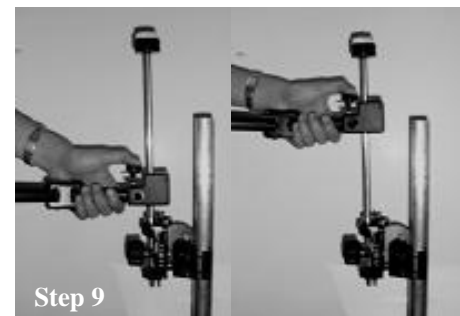

10. Turn the release knob clockwise until it is tight. This secures the multilink arm to the rod, preventing it from moving vertically or rotating on the rod. It also serves as an additional safety lock. (Note: The release knob must be turned counter-clockwise in order to make vertical adjustments or remove the device from the rod)

11. Screw the bubble level back into the top of the rod, or place a soft ball over it for safety.