

JAECO Mount Relocator Application Reference

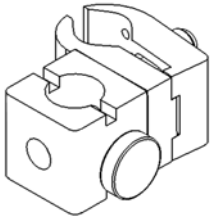

MR-10

JAECO Standard Mount Relocator

Mount Base clamps to tubular back posts

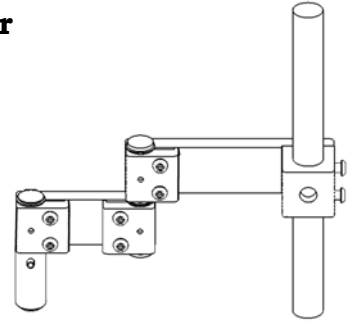
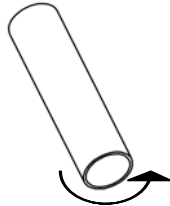
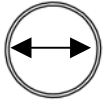

JAECO Relocator Arm

Features articulated arms with 10 inch mount shaft. Supplied with all of the new **JAECO Mount Relocators**

Diameter

3/4 inch

Circumference

2 and 1/2 inches (64 mm)

7/8 inch

2 and 7/8 inches (73 mm)

1 inch

3 and 1/4 inches (82 mm)

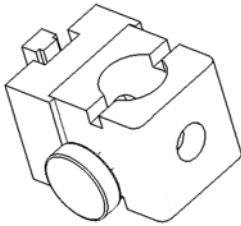

MR-8

JAECO Mount Relocator for Keyed Back Post

Attaches to wheelchairs with Keyed back posts.

Invacare 2nd Generation, Motion Concept seating systems, ect...

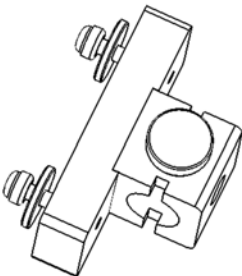
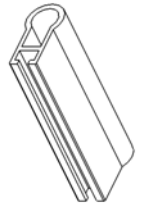

MR-7

JAECO Mount Relocator for Molded Backrest

Attaches to plastic or metal molded backrests when back posts are restricted or not present.

Permobil, Kid-Carts, ect...

Note: *All Mount Bases will interchange with Relocator Arm. Custom Mount Bases fabricated upon request.*

MR-12: JAECO Evaluation Mount Relocator

Relocator Arm with all three Mount Bases